

Courtesy:- <http://www.cumminspower.com/>

Typical enclosed genset dimensions\*

Model	Prime Rating (kVA)	Engine Model	Enclosure Dimensions		
			Length (mm)	Width (mm)	Height (mm)
CJ 15 D5 P	15	X 1.7 G1	2200	900	1375
CJ 20 D5 P	20	X 2.5 G1	2200	900	1375
CJ 25 D5 P	25	X 2.5 G2	2200	900	1375
CJ 30 D5 P	30	S 3.8 G2	2800	1150	1450
CJ 35 D5 P	35	S 3.8 G3	2800	1150	1450
CJ 40 D5 P	40	S 3.8 G4	2800	1150	1575
CJ 50 D5 P	50	S 3.8 G6	2800	1150	1575
CJ 62.5 D5 P	62.5	S 3.8 G7	2950	1150	1575
CJ 75 D5 P	75	6BT 5.9 G1	3850	1150	1700
CJ 82.5 D5 P	82.5	6BT 5.9 G1	3850	1150	1700
CJ 100 D5 P	100	6BTA 5.9 G1-I	4000	1150	1700
CJ 125 D5 P	125	6BTA 5.9 G2-I	4000	1150	1700
CJ 140 D5 P	140	6BTAA5.9 G1-I	4000	1150	1700
CJ 160 D5 P	160	6CTA 8.3 G1-I	4500	1500	1850
CJ 180 D5 P	180	6CTA 8.3 G2-I	4500	1500	1850
CJ 200 D5 P	200	6CTAA8.3 G1-I	4500	1500	1850
CJ 250 D5 P	250	6CTAA 8.3 G4	4650	1700	2050
CJ 320 D5 P	320	NTA 855 G2-I	5500	2000	2520
CJ 380 D5 P	380	NTA 14 G3	5500	2000	2520
CJ 500 D5 P	500	KTA 19 G9	6500	2000	2300
CJ 600 D5 P	600	VTA 28 G3-I	7000	2500	2925
CJ 625 D5 P	625	VTA28 G5-I	7000	2500	2925
CJ 750 D5 P	750	KTA 38 G2-I	7500	2500	2925

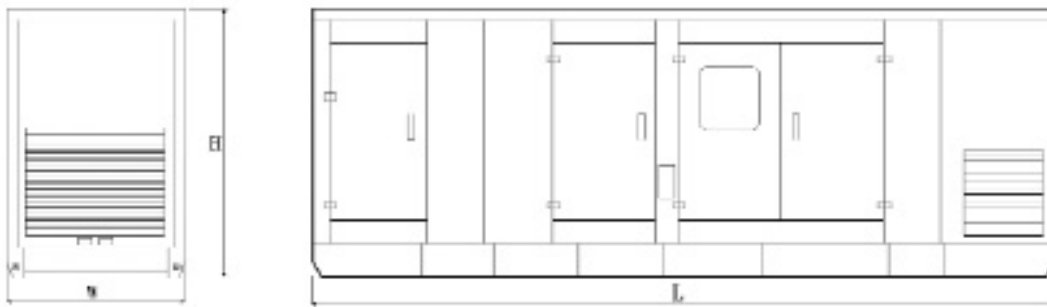

\* Dimensions of the enclosure are excluding the silencer.  
 The information contained in this publication is typical only. It does not form part of any contractual commitment and is subject to change without notice.